

Pin Power Inductor

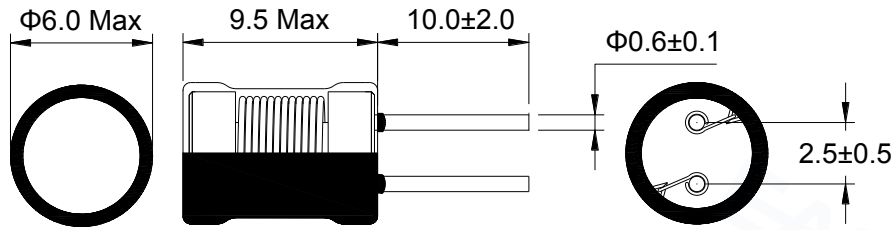

1 Appearance and dimensions (mm) 外形尺寸



2 Reference land pattern (mm) 参考基板尺寸

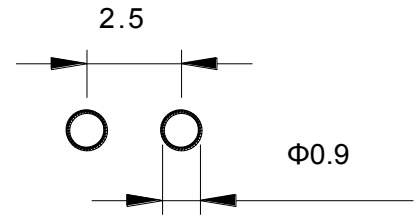

3 Electrical characteristics 电气特性

Part No. 型号	Inductance (μH) 电感值 ※1 ±10%	D.C.R. (mΩ) 直流电阻		Saturation current (A) 饱和电流 ※2		Temperature rise current (A) 温升电流 ※3
		Typical	Max	Typical	Max	Typical
DR2W0507-100K	10.0	42.0	50.4	2.30	1.84	2.96
DR2W0507-120K	12.0	52.9	63.5	2.10	1.68	2.64
DR2W0507-150K	15.0	60.2	72.2	1.70	1.36	2.48
DR2W0507-180K	18.0	70.3	84.3	1.65	1.32	2.09
DR2W0507-220K	22.0	83.9	101	1.40	1.12	1.92
DR2W0507-270K	27.0	107	128	1.25	1.00	1.70
DR2W0507-330K	33.0	120	144	1.20	0.96	1.60
DR2W0507-390K	39.0	154	185	1.15	0.92	1.39
DR2W0507-470K	47.0	173	207	1.10	0.88	1.32
DR2W0507-560K	56.0	237	285	0.97	0.78	1.12
DR2W0507-680K	68.0	266	319	0.90	0.72	1.06
DR2W0507-820K	82.0	300	360	0.80	0.64	1.00
DR2W0507-101K	100	394	473	0.75	0.60	0.87
DR2W0507-121K	120	431	517	0.63	0.50	0.83
DR2W0507-151K	150	581	697	0.56	0.45	0.72
DR2W0507-181K	180	647	777	0.49	0.39	0.68
DR2W0507-221K	220	738	886	0.45	0.36	0.64
DR2W0507-271K	270	931	1,117	0.40	0.32	0.57
DR2W0507-331K	330	1,088	1,305	0.38	0.30	0.52
DR2W0507-391K	390	1,434	1,721	0.36	0.29	0.45
DR2W0507-471K	470	1,601	1,921	0.32	0.26	0.43
DR2W0507-561K	560	1,987	2,385	0.28	0.22	0.39
DR2W0507-681K	680	2,276	2,731	0.27	0.22	0.36
DR2W0507-821K	820	3,157	3,788	0.23	0.18	0.31
DR2W0507-102K	1,000	3,681	4,417	0.22	0.18	0.28

All data is tested based on 25 °C ambient temperature. 所有测试数据基于环境温度25 °C条件下测试。

※1. Inductance measure condition at 1kHz, 0.25V. 电感测试条件为1kHz, 0.25V.

※2. Saturation current the actual value of DC current when the inductance decrease 20% of its initial value.
饱和电流：电感值下降其初始值的20%时所加载的实际直流电流值。

※3. Temperature rise current the actual value of DC current when the temperature rise is Δ T40 (Ta=25).
温升电流：使产品温度上升到 Δ T40 °C 时所加载的实际直流电流值(Ta=25 °C)