

RF Balun Transformer

EBW2-32-B012571

2022-03-01 Rev. 2

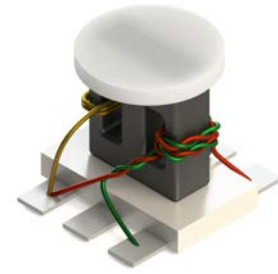

50Ω 1:2 Transmission Line Transformer 10-3000 MHz

Outline Drawing(mm)

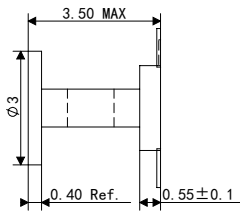
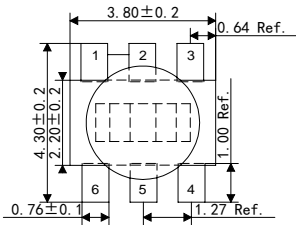

Electrical structure

Fig W

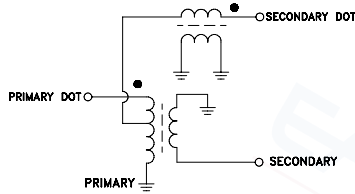

Recommended layout(mm)

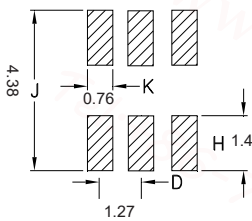

Pin Connections

Input	6
Output 1	4
Output 2	3
Ground	2, 5

Features

- Operating temperature range: -40°C to +85°C
- Storage temperature range: -55°C to +100°C
- 260°C Reflow Compatible
- RoHS Compliant and Lead free
- Input Power: 0.40W Max
- DC Current: 30 mA

Applications

- Impedance matching
- Balanced amplifier
- Balun
- Cellular and VHF

Electrical Specifications: TA=25°C, 0dBm, Z0=50Ω

Parameter	Test Conditions	Units	Min	Typ	Max
Main line Loss (Pin6-4)	10-3000MHz	dB	—	2.0	3.5
Main line Loss (Pin6-3)	10-3000MHz	dB	—	1.0	2.0
Amplitude Balance	10-3000MHz	dB	—	2.0	3.0
Phase Balance	10-3000MHz	°	—	8.0	20.0
Input Return Loss(Pin6)	10-3000MHz	dB	15.0	20.0	—

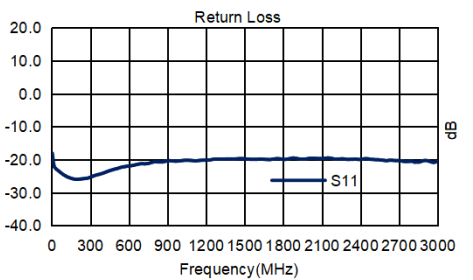
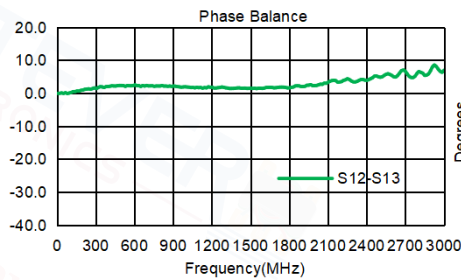
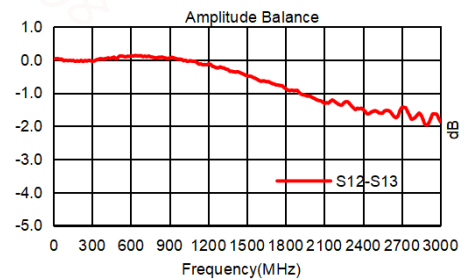
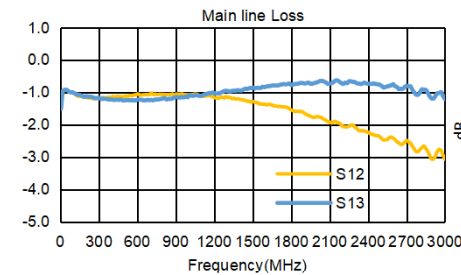

Carrier Tape Orientation

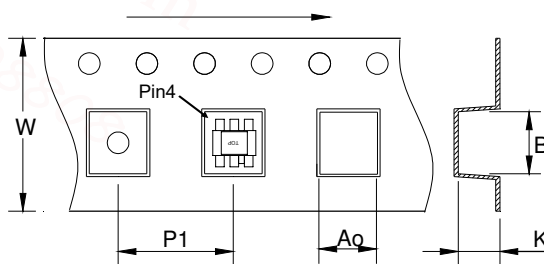

Tape & Reel Information

Parameter	Units	Value
Qty per reel	PCS	2000
Reel Size	mm	330
Tape Width	mm	12.00
Pitch	mm	8.00
Ao	mm	4.50
Bo	mm	4.50
Ko	mm	3.20